



# SMART SPAIR®

EMERGENCY FLAT TIRE REPAIR

## Smart Spair® Kit includes:

- 16oz. (473 ml) bottle of Slime Tire Sealant with filler hose
- Tire inflator with built-in pressure gauge
- Valve core removal tool and air adapters for inflatables



## ! ATTENTION! READ ALL INSTRUCTIONS CAREFULLY.

Failure to follow warning instructions can result in fire, injury to persons or property damage.

PART #: 40013\_Instructions 04.07.15



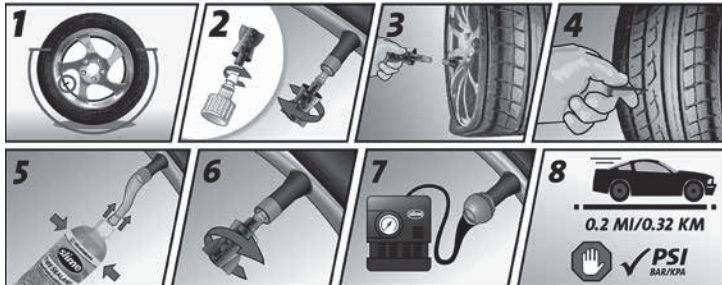

### INSTALLATION INSTRUCTIONS



Repairing a flat tire with a Smart Spair is simple and takes less than 15 minutes.

1. Start by rotating tire so that the valve stem is in the lower half of the tire.
2. Slowly remove the valve core with valve core tool provided. Take care to keep a hold of the valve core as remaining pressure in the tire can cause the core to shoot out.
3. Allow the tire to fully deflate.
4. Remove the puncturing object if possible.
5. Place white cap on sealant bottle. Attach filler tube to the bottle tip and tire valve stem and squeeze in recommended amount of Slime Tire Sealant.
6. Replace the valve core.
7. Plug the tire inflator into the power outlet. Turn on the inflator and air up the tire. Use the built-in tire pressure gauge to monitor inflation progress. Once your correct tire pressure has been reached, turn off the inflator and disconnect the power adapter. (The manufacturer's recommended tire pressure can be found in the owner's manual and/or the driver's side door jamb.)
8. Drive for .2 mi (.32km) and stop to verify that the puncture has been sealed. Check tire pressure. Reinflate if necessary.

## HOW MUCH SEALANT PER TIRE?

 MOTORCYCLE	8 oz. (237 mL)	 CAR	16 oz. (473 mL)
 SCOOTER	8 oz. (237 mL)	 TRAILER	16 oz. (473 mL)

### Troubleshooting:

#### Inflator fails to operate when plugged in:

1. The fuse, located in the plug adapter, may have blown.
2. Unscrew the tip of the plug adapter, remove fuse and inspect. If necessary, replace fuse with AGC 15A fuse.



#### Inflator does not start and fuse has been checked:

1. Push the power plug firmly into the power accessory outlet and twist it back and forth.
2. Check power accessory outlet for debris and remove if necessary. Use a nonconductive probe; not fingers or metal.
3. Be sure vehicle power outlet fuse is at least 15 amps. (Vehicle may need to be turned on to power auxiliary port.)

#### Inflator runs but does not inflate:

1. Be sure the connector is on the valve stem as far as possible before closing locking lever.
2. Check tire for leaks and check hose for breaks and leaks at fittings.

#### Inflator runs slowly:

1. The unit may have overheated from excessive use. Shut it off and allow it to cool for 25 minutes.
2. Voltage may be too low. Check condition of vehicle's battery.

**NOTE:** If tire is totally deflated, it is possible that the tire could separate from the rim, allowing air to leak out when trying to inflate. In the event this occurs, jack up the vehicle to aid inflation. If this does not work call roadside assistance.

**CAUTION: Keep inflator out of reach of children.** Always use a tire gauge to check the actual pressure in tires. Do not overinflate tire.

#### CAUTION:

- Tires can be repaired only if the punctures are on the tread area and smaller than 1/4 inch (6 mm).
- Sidewall holes cannot be repaired.
- Tires on damaged rims cannot be repaired if the rim is so deformed that air escapes.

#### IMPORTANT:

- To avoid overheating do not use the inflator continuously for more than 10 minutes. Allow the inflator to cool 25 minutes between uses.
- Warm the tire sealant before installing.
- Slime is non-toxic and easily washes away with water.

#### WARNINGS:

Slime is a temporary repair when used in passenger vehicles. Seek a permanent professional repair. Slime will remain liquid, which may result in imbalance or vibration. If vibration occurs, seek an immediate professional repair. Eye protection must be worn during installation. Inspect tires regularly for perforating objects and punctures.

## SEALANT REMOVAL INSTRUCTIONS

### FOR THE TIRE REPAIR PROFESSIONAL

Slime tire sealant is non-flammable and water based so clean up is simple. The sealant should be rinsed or wiped out of the tire prior to making a permanent repair. Should any sealant fall on the shop floor, simply wipe it up with a rag and rinse off the area with water. If TPMS sensor present, wipe sensor with damp rag prior to reinstallation. This sealant will not corrode or negatively affect the rim or tire.

Limited Warranty: For the period of one year from date of purchase, manufacturer guarantees that this Product will meet the specifications when used as directed. Manufacturer's sole liability and Customer's sole remedy under any warranty claim is limited to refund of purchase price or new product upon return of unit and proof of purchase.

QUESTIONS OR COMMENTS: Call 888-45-SLIME or visit [www.slime.com](http://www.slime.com)

ITW Global Tire Repair 125 Venture Drive, Suite 210, San Luis Obispo, CA 93401 USA

Slime® is a trademark of Illinois Tool Works, Inc., registered in the U.S. and other countries.